

Little Green

1400, 1425, 50Y6 Series

Leak

****NOTE**:** When the solution tank is filled and turned right side up, the straw on the insert may fill with water/solution causing the tank to leak for a couple of seconds. This leaking should subside after the straw empties out.

- 1) **Check to see if the solution tank/cap insert is leaking.** Completely remove cap and insert, and reattach. If cap still leaking, a new cap and insert will need to be ordered.

Machine is Leaking Out of the Bottom

- 1) **Remove the solution tank, fill with water, and see if it is leaking freely (while removed from the machine).**

If **YES**, the solution tank is leaking... a new cap and insert will need to be ordered.

If **NO**, the solution tank is not leaking...

- a) **Remove the collection tank and see if there is water sitting in the receiving area.**

If YES, water is in receiving area....

- **Make sure the black “duck bill” gasket** is not missing from the collection tank or inserted wrong (the tall “duck bill” side of the gasket should be inserted into the opening on the outer, rounded side of the tank). Ensure the gasket is open by taking it out and squeezing the tall “duck bill” flap, forcing it open on the end.

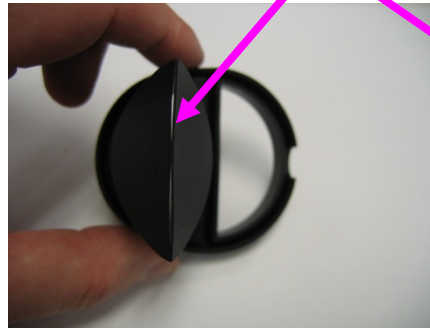

Gasket stuck closed

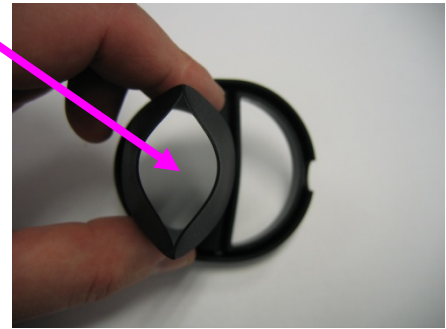

Squeeze sides to force open

- **Check to make sure the float in the collection tank is operating properly.** Empty the collection tank and turn it over repeatedly. The float should slide easily back and forth. If the float is stuck in the open position, water can get into the housing of the machine.

If NO water in receiving area, please contact one of our Authorized Service Centers to have a quality technician inspect your unit.