

Bissell®

SPOTCLEAN TURBO

USER GUIDE
15582



IMPORTANT SAFETY INSTRUCTIONS

READ ALL INSTRUCTIONS BEFORE USING YOUR APPLIANCE.

When using an electrical appliance, basic precautions should be observed, including the following:



WARNING

TO REDUCE THE RISK OF FIRE, ELECTRIC SHOCK OR INJURY:

- » This appliance can be used by children aged from 8 years and above and persons with reduced physical, sensory or mental capabilities or lack of experience and knowledge if they have been given supervision or instruction concerning use of the appliance in a safe way and understand the hazards involved. Cleaning and user maintenance shall not be made by children without supervision.
- » Children should be supervised to ensure that they do not play with the appliance.
- » Unplug from electrical socket when not in use, before cleaning, maintaining, or servicing the appliance.
- » Do not immerse in water or liquid.
- » Keep hair, loose clothing, fingers, and all parts of body away from openings and moving parts of the appliance and its accessories.
- » Do not immerse. Use only on surfaces moistened by the cleaning process. Use only BISSELL® cleaning products intended for use with this machine.
- » Use only the type and amount of liquids specified under the operations section of this guide.
- » Use only on carpet moistened by the cleaning process.
- » Liquid must not be directed towards equipment containing electrical components.
- » Always connect to a properly earthed electrical socket. Do not modify earthed plug.
- » Always install float before any wet pick-up operation.
- » Plastic film can be dangerous. To avoid danger of suffocation, keep away from children.
- » Use only as described in this user guide.
- » Use only manufacturer's recommended attachments.
- » If appliance is not working as it should, has been dropped, damaged, left outdoors, or dropped into water; do not attempt to operate it and have it repaired at an authorised service center.
- » Do not put any object into openings.
- » Do not use with any opening blocked; keep free of dust, lint, hair, and anything that may reduce air flow.
- » Use extra care when cleaning on stairs.
- » Do not use to pick up flammable or combustible liquids, such as petroleum, or use in areas where they may be present.
- » Do not pick up toxic material (chlorine bleach, ammonia, drain cleaner, etc.).
- » Do not use appliance in an enclosed space filled with vapours given off by oil-based paint, paint thinner, some moth-proofing substances, flammable dust, or other explosive or toxic vapours.
- » Do not pick up hard or sharp objects such as glass, nails, screws, coins, etc.
- » Do not pick up anything that is burning or smoking, such as cigarettes, matches or hot ashes.
- » Do not use without filters in place.
- » Indoor use only.
- » If the supply cable is damaged, it must be replaced by the manufacturer, its service agent or similarly qualified person in order to avoid a hazard.
- » Do not run appliance over cable.
- » Do not leave appliance when plugged in.
- » Do not use with damage cable or plug.
- » Do not pull or carry by cable, use cable as a handle, close door on cable, or pull cable around sharp edges or corners.
- » Keep cable away from heated surfaces.
- » To unplug, grasp the plug, not the cable.
- » Do not handle plug or appliance with wet hands.
- » Turn OFF all controls before unplugging.
- » Always install float before any wet pick-up operation.

SAVE THESE INSTRUCTIONS

ORIGINAL INSTRUCTIONS. FOR OPERATION ON A 220-240 VOLT A.C. 50-60 HZ POWER SUPPLY ONLY.

THIS MODEL IS FOR HOUSEHOLD USE ONLY.

IMPORTANT INFORMATION

- » Keep appliance on a level surface.
- » To reduce the risk of a leaking condition, do not store unit where freezing may occur. Damage to internal components may result.

Thanks for buying a BISSELL® portable spot cleaner

We're glad you purchased a BISSELL portable spot cleaner. Everything we know about floor care went into the design and construction of this complete, high-tech home cleaning system.



Your BISSELL portable spot cleaner is well made, and we back it with a limited two year guarantee. We also stand behind it with a knowledgeable, dedicated Consumer Care department, so, should you ever have a problem, you'll receive fast, considerate assistance.

My great-grandfather invented the floor sweeper in 1876. Today, BISSELL is a global leader in the design, manufacture, and service of high quality homecare products like your BISSELL portable spot cleaner.

Thanks again, from all of us at BISSELL.

Mark J. Bissell
Chairman & CEO

Safety Instructions.....	2
Product View.....	4
Assembly	5
Operations	6
Maintenance & Care	7
Troubleshooting	7
Guarantee.....	8
Consumer Care.....	8

	WARNING	AN ACTION OR ATTENTION IS NEEDED TO THIS AREA IN ORDER TO REDUCE THE RISK OF ELECTRIC SHOCK, FIRE OR INJURY
	GUIDE	READ USER GUIDE FOR COMPLETE SAFETY AND USER INSTRUCTIONS
	WEEE	DO NOT THROW THE APPLIANCE AWAY WITH THE NORMAL HOUSEHOLD WASTE AT THE END OF ITS LIFE, BUT HAND IT IN AT AN OFFICIAL COLLECTION POINT FOR RECYCLING. BY DOING THIS YOU WILL HELP TO PRESERVE THE ENVIRONMENT.

Product View



Cleaning Formulas

Note: Always use genuine BISSELL® cleaning formulas for portable carpet and upholstery washers in your machine.

Pretreat

Pretreat spots and stains to improve cleaning performance.

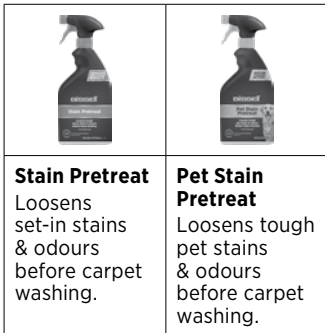

Formula

Keep plenty of BISSELL cleaning formulas on hand so you can clean whenever it fits your schedule.



Boost

Add to any formula to increase its effectiveness.



WARNING

To reduce the risk of fire and electric shock due to internal component damage, use only BISSELL cleaning formula intended for use with this machine. Use of cleaning formulas that contain eucalyptus, lemon or pine oil may damage this appliance and may void the guarantee. Chemical spot cleaners or solvent-based soil removers should not be used. These products may react with the plastic materials used in your carpet washer causing cracking or pitting.

Assembly

Before You Clean

1. Remove loose dirt and impediments before deep cleaning.
2. Pretreating (optional):
 - 2a. Pretreating is recommended to improve cleaning effectiveness for heavily soiled carpet in high traffic areas such as entryway and hallways.
 - 2b. **BISSELL® Stain Pretreat**

Spray the BISSELL Stain Pretreat formula onto heavy traffic areas, soiled areas or stains. Allow to penetrate for at least 3 minutes. Clean as normal, following the instructions below.

ATTENTION

Some Berber carpets have a tendency to fuzz with wear. Repeated strokes in the same area may aggravate this condition.

2b.



Preparing the Machine

1. Release Flex Hose by twisting the hose secure latch clockwise. Unwrap flex hose completely.
2. Attach the Large Stain Tool or Tough Stain Tool to the hose grip until it snaps together. Make certain the tool is securely attached.
3. Twist the Quick Release Cable Wrap clockwise to unwrap the power cable completely and plug into grounded outlet.

Filling the Formula & Clean Water Tank

1. Remove tank from the back of the machine by lifting up tank carry handle.

Note: This tank was designed with a flat bottom so it can be easily filled.
2. Unscrew the black cap and remove bottle insert.
3. Fill tank with hot tap water (140° F/60° C MAX) to the water fill line. Add 60 mL of BISSELL formula to the tank.
4. Replace the bottle insert in the tank and tighten the black cap. Replace the tank on the machine.

Tip

Make only one trip to the sink by bringing the entire portable cleaner. Fill and empty in the same trip.

1.



2.



Operations

Cleaning with your Spot Cleaner

1. Plug unit in and turn ON by pressing Power Button.
2. Hold cleaning tool approximately 2.5cm above soiled surface. Press spray trigger to apply cleaning solution to soiled area.
3. Using the brush on the cleaning tool, gently scrub area to be cleaned.
4. For thorough cleaning, spray additional solution while brush and suction are in contact with surface.
5. Apply downward pressure on cleaning tool and pull it toward you. The suction will remove the dirt and cleaning solution. Continue until no more dirt can be removed.
6. As a final step, use “drying strokes” (by not pressing the spray trigger) to remove as much liquid/moisture as possible. Repeat this step as often as necessary.

WARNING

Keep spray away from face. Failure to do so may result in personal injury.

IMPORTANT

Check the manufacturer's tag before cleaning upholstery. Test a small, hidden area for colourfastness. If colour is affected, do not use. If manufacturer's tag is missing or not coded, check with your furniture dealer.

Emptying the Dirty Water Tank

1. When the Dirty Water Tank reaches the “FULL” line on the tank it is time to empty.
2. Remove Dirty Water Tank and carry to a utility sink, toilet or outside (where you will dispose of the dirty water).
3. To unlock the Dirty Water Tank lid, rotate handle over the back of the tank. Remove lid and pour out dirty water. Rinse out Dirty Water Tank to remove any debris.
4. Replace top of tank, and rotate the handle forward to lock in place on front of tank.
5. Before replacing tank on machine, wipe debris from red filter.

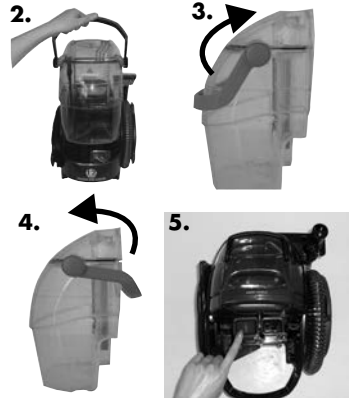

Cleaning your Machine

1. Remove and rinse the tools under clean, running water. Allow tools to dry.
2. It is recommended that you suction clean water from a bowl to rinse out the hose. Then lift end of hose and stretch out to ensure all water is cleared from hose.
3. Wrap the Flex Hose around the hose wrap and secure with latch.

Tip

For best results empty, rinse and dry tanks and tools before storing.

Maintenance & Care

Machine Care (check regularly)

Cleaning Debris Filter

1. Remove all hair and debris from the red filter.
2. Place the Dirty Water Tank back onto the machine.

Debris Filter



⚠️ WARNING

To reduce the risk of fire, electric shock, or injury, turn power OFF and disconnect plug from electrical outlet before performing maintenance or troubleshooting.

Troubleshooting

⚠️ WARNING

To reduce the risk of electric shock, turn power OFF and disconnect plug from electrical outlet before performing maintenance or troubleshooting checks.

Problem	Possible causes	Remedies
Reduced spray or no spray	Formula and Clean Water Tank may be empty	Refill tank
	Formula and Clean Water Tank may not be seated completely	Turn power OFF; Remove and reseal tank
	Pump may have lost prime	Hold end of hose below water level in tank to prime
Loss of suction power	Tanks may not be seated properly	Pick up both tanks and reseal them so they fit snugly on the unit
	Dirty Water Tank has picked up maximum amount of dirty water and has reached full line	Empty Dirty Water Tank
	Formula and Clean Water Tank is empty	Check fluid levels in Formula and Clean Water Tank

Consumer Guarantee

This guarantee gives you specific legal rights, in addition to rights you may have under the Australian Consumer Law. If you need additional instruction regarding this guarantee or have questions regarding what it may cover, please contact your local BISSELL Consumer Services on the details set out below.

Limited 2 Year Guarantee (from the date of purchase by original purchaser)

Subject to the *CONDITIONS identified below, BISSELL will repair or replace (with new, refurbished, lightly used, or remanufactured components or products), at BISSELL's option, free of charge, any defective or malfunctioning part due to manufacturer defect. This guarantee applies to product used for personal purposes, and not commercial or rental service. This guarantee does not apply to fans or routine maintenance or consumable components such as filters, belts, brush rolls, etc., damage or malfunction caused by negligence, abuse, neglect, unauthorized repair, or any other use not in accordance with the user guide. BISSELL recommends that the original packaging be kept for the duration of the guarantee period in case such need arises within the guarantee period that the item needs re-packing and transportation.

It may be necessary to obtain some of your personal information, such as a mailing address, to fulfill terms of this guarantee. Any personal data will be handled pursuant to BISSELL's Privacy Policy, which can be found at www.BISSELL.eu.

*CONDITIONS OF THE GUARANTEE

Subject to whether such loss is reasonably foreseeable, BISSELL and its in-country distributors are not liable for incidental or consequential damages of any nature associated with the use of this product.

FOR AUSTRALIAN CONSUMERS ONLY:

OUR GOODS COME WITH GUARANTEES THAT CANNOT BE EXCLUDED UNDER THE AUSTRALIAN CONSUMER LAW. YOU ARE ENTITLED TO A REPLACEMENT OR REFUND FOR A MAJOR FAILURE AND FOR COMPENSATION FOR ANY OTHER REASONABLY FORESEEABLE LOSS OR DAMAGE. YOU ARE ALSO ENTITLED TO HAVE THE GOODS REPAIRED OR REPLACED IF THE GOODS FAIL TO BE OF ACCEPTABLE QUALITY AND THE FAILURE DOES NOT AMOUNT TO A MAJOR FAILURE.

THIS GUARANTEE IS IN ADDITION TO OTHER RIGHTS OR REMEDIES UNDER LAW. NOTHING IN THIS GUARANTEE EXCLUDES, LIMITS OR MODIFIES ANY LIABILITY OF BISSELL WHICH IS IMPOSED BY LAW, OR LIMITS OR MODIFIES ANY REMEDY AVAILABLE TO THE CONSUMER WHICH IS GRANTED BY LAW. TO MAKE A CLAIM UNDER THIS GUARANTEE CONTACT BISSELL AUSTRALIA PTY LTD (DETAILS BELOW). CONTACT BISSELL PRIOR TO RETURNING ANY GOODS. WHERE AGREED, BISSELL WILL REIMBURSE REASONABLE POSTAGE / HANDLING COSTS (IF ANY) FOR RETURNING GOODS TO BISSELL. TO CLAIM EXPENSES INCURRED IN MAKING A CLAIM UNDER THIS GUARANTEE PLEASE PROVIDE BISSELL WITH A COPY OF THE RECEIPT OF THE EXPENSES BY EMAIL OR POST.

Consumer Care

If your BISSELL® product should require service or to claim under our limited guarantee, please contact us as follows:

Website and Email:

www.BISSELL.com.au

www.BISSELL.co.nz

Telephone:

Australia: 1300-247-735

New Zealand: 0800-247-735

Write:

BISSELL AUSTRALIA PTY LIMITED

42 Rocco Dr.

Scoresby 3179

Victoria

Australia

Replacement parts and accessories are available for purchase.

To purchase visit global.BISSELL.com.

Visit the BISSELL website: global.BISSELL.com

When contacting BISSELL, have model number of cleaner available.

Please record your Model Number: _____

Please record your Purchase Date: _____

NOTE: Please keep your original sales receipt. It provides proof of the date of purchase in the event of a guarantee claim. See guarantee for details.



©2020 BISSELL Inc.
All rights reserved. Printed in China
Part Number 16Z3604 01/20