



CROSSWAVE[®]

EDGE CORDLESS

ALL-IN-ONE MULTI-SURFACE CLEANER

4328F SERIES

Carton Contents	3
Assembly & Charging the Battery	3
Filling the Clean Water Tank.....	4
Cleaning Your Floors	5
Emptying the Dirty Water Tank	6
Using the Clean-Out Cycle.....	7
Cleaning and Storing Your Machine.....	8
Warranty	11



Li-Ion

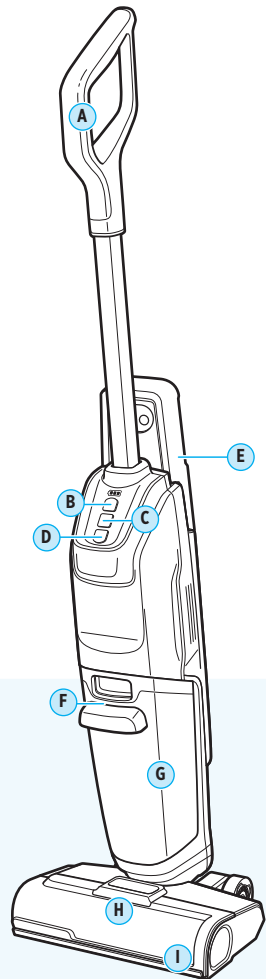

Product Overview

- A. Handle
- B. Power Button
- C. Multi-Surface Button
- D. Clean-out Cycle Button
- E. Clean Water Tank
- F. Dirty Water Tank Release Button
- G. Dirty Water Tank with Filter
- H. Brush Roll Window Release Button
- I. Brush Roll Window

SYMBOL	EXPLANATION
	Caution.
	Read operator's manual.
	Risk of fire.
	Risk of electric shock.
	For indoor use only.
	Do not expose to rain.
	Do not overwet carpet. Use only on carpet moistened by the cleaning process.
	Use only BISSELL® cleaning formulas intended for use with this machine.
	Protection against moving parts.
	Risk of automatic start-up.
	Always turn unit off prior to charging.
	Detachable power supply unit.
	This symbol on the product and/or accompanying documents means that used electrical and electronic products should not be mixed with general household waste. For proper treatment, recovery and recycling, please take this product to designated collection points. Please contact your local authority for further details of your nearest designated collection point.

SYMBOL	EXPLANATION
	This symbol means to recycle. Do not mix batteries with general household waste. Recycle used batteries at your nearest recycling center.
	Allow parts to dry.
	Use warm water, temperature up to 60°C.
	Check the manufacturer's tag before cleaning textile. "W" on the tag as shown means you can use your cleaner.
	Lock.
	Do not freeze.
	Direct current.
	Suitable for use by children at least 8 years old.
	Recycle Li-Ion battery.
	Corrugated Recycles.
	Warning: Slippery surface.
	Clean out cycle. Automatic self-cleaning cycle after use.
	Corrugated fibreboard
	Paper

IMPORTANT SAFETY INSTRUCTIONS



READ ALL INSTRUCTIONS BEFORE USING YOUR APPLIANCE.

When using an electrical appliance, basic precautions should be observed, including the following:

WARNING

TO REDUCE THE RISK OF FIRE, ELECTRIC SHOCK OR INJURY:

- This appliance is not intended for use by persons (including children) with reduced physical, sensory or mental capabilities, or lack of experience and knowledge, unless they have been given supervision or instruction concerning use of the appliance by a person responsible for their safety.
- Children should be supervised to ensure that they do not play with the appliance.
- Floor slippery when wet.
- The appliance has to be unplugged after use and before carrying out user maintenance on the appliance.
- Unplug the charger from electrical socket when not in use, before cleaning maintaining or servicing the appliance.
- Read all instructions before using your appliance.
- If the battery charger is damaged, it must not be used until it has been repaired.
- Use indoors only.
- Use only cleaning products intended for use with this appliance to prevent internal component damage. See the Cleaning Formulas section of this guide.
- Do not allow to be used as a toy. Close attention is necessary when used by or near children.
- Do not use for any purpose other than described in this user guide. Use only manufacturer's recommended attachments.
- If the charger supply cable is damaged, it must be replaced by the manufacturer, its service agent or similarly qualified person in order to avoid a hazard.
- Do not pull or carry by cord, use cord as a handle, close door on cord, or pull cord around

sharp edges or corners. Do not run appliance over cord. Keep cord away from heated surfaces.

- Do not unplug charger by pulling on cord. To unplug, grasp the plug, not the cord.
- Do not handle charger plug or appliance with wet hands.
- Do not put any object into openings. Do not use with any opening blocked; keep openings free of dust, lint, hair, and anything that may reduce air flow.
- Keep hair, loose clothing, fingers, and all parts of body away from openings and moving parts of the appliance and its accessories.
- Turn OFF all controls before plugging or unplugging charger.
- Use extra care when cleaning on stairs.
- Do not use to pick up flammable or combustible materials (lighter fluid, gasoline, kerosene, etc.) or use in areas where they may be present.
- Do not pick up anything that is burning or smoking, such as cigarettes, matches, or hot ashes.
- Do not use without filters in place.
- Risk of injury from moving parts. brush may start unexpectedly. Unplug before cleaning or servicing.
- Do not turn your appliance ON until you are familiar with all instructions and operating procedures.
- Do not use appliance in an enclosed space filled with vapors given off by oil-based paint, paint thinner, some moth-proofing substances, flammable dust, or other explosive or toxic vapors.
- Do not use to pick up toxic material (chlorine bleach, ammonia, drain cleaner, etc.)
- Plastic film can be dangerous. To avoid danger of suffocation, keep away from children.

Warnings (continued)

- This appliance can be used by children aged from 8 years and above and persons with reduced physical, sensory or mental capabilities or lack of experience and knowledge if they have been given supervision or instruction concerning use of the appliance in a safe way and understand the hazards involved. Children shall not play with the appliance. Cleaning and user maintenance shall not be made by children without supervision.
- CAUTION: Only allow children at least 8 years old to use the battery charger. Give sufficient instruction so that the child is able to use the battery charger in a safe way and explain that it is not a toy and must not be played with. Instruct the child not to try and recharge non-rechargeable batteries because of the danger of eruption.
- Recycle batteries, do not mix with household waste.
- The appliance is only to be used with the power supply unit provided with the appliance.
- For the purposes of recharging the battery, only use the detachable supply unit provided with this appliance.
- Unplug charger from electrical socket when not in use, before cleaning, maintaining or servicing the appliance, and if your appliance has an accessory tool with a moving brush, before connecting or disconnecting the tool.
- This appliance must only be supplied at safety extra low voltage corresponding to the marking on the appliance.
- If appliance is not working as it should, has been dropped, damaged, left outdoors, or dropped into water; do not attempt to operate it and have it repaired at an authorised service center.
- Liquid must not be directed toward equipment containing electrical components.
- Use only the type and amount of liquids specified under the operations section of this guide.
- Do not use non-rechargeable batteries.
- This appliance contains lithium ion type batteries that are non-replaceable.
- Do not charge with damaged charger or plug. If appliance is not working as it should, has been dropped, damaged, left outdoors or dropped into water, have it repaired by a qualified technician.
- Recharge appliance only with the charger specified by the manufacturer. A charger that is suitable for one type of battery pack may create a risk of fire when used with another battery pack.
- Do not expose battery pack or appliance to fire or excessive temperature. Exposure to fire or temperature above 130°C may cause explosion.
- Always install float before any wet pick-up operation.
- Do not incinerate the appliance even if it is severely damaged. The batteries can explode in a fire.
- Unplug before connecting to docking station.
- Use only with charger E-TEK Model ZD024A300075AU.

SAVE THESE INSTRUCTIONS

ORIGINAL INSTRUCTIONS.





FOR OPERATION ON A 220-240 VOLT A.C. 50-60 HZ POWER SUPPLY ONLY.

THIS MODEL IS FOR HOUSEHOLD USE ONLY.

IMPORTANT INFORMATION

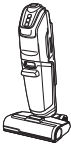
- To reduce the risk of a leaking condition, do not store where freezing may occur. Damage to internal components may result.
- Keep appliance on a level surface.
- If your appliance has a motorised brush roll, do not leave machine running in the same spot without the handle fully upright.
- Plastic tanks are not dishwasher safe. Do not put tanks in dishwasher.

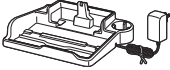
What's in the Box?

				
Body	Handle	Trial Formula/Filter	3-in-1 Docking Station + Charging Cable	Clean Tank

Assembly & Charging the Battery

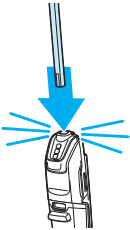
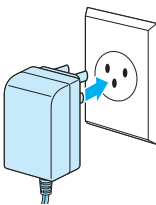
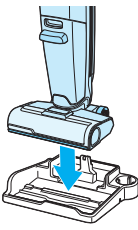
		
1. Firmly install handle into body of machine until it clicks into place.	2. Install charging cable plug into outlet.	3. Place machine on docking station and ensure charging icon is lit up.

Assembly & Charging the Battery continued



4. Let charge for 3 hours or until battery reaches 100% charge.

Note: Remove cardboard insert from bottom of foot before first use.

Filling the Clean Water Tank

For optimal performance, use genuine BISSELL® formulas in your machine. Other formulas or household cleaners like vinegar may cause defects or damage to the machine.

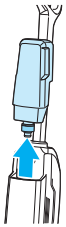

1. Pull clean water tank up to remove.



2. Unscrew cap.

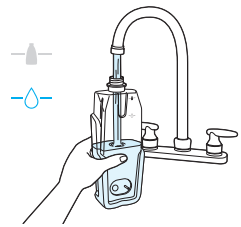

3. Fill clean water tank with warm water (140°F/60°C) to water fill line (620mL).

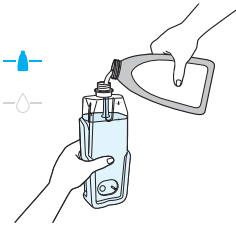

4. Add formula* to the formula line (88mL).

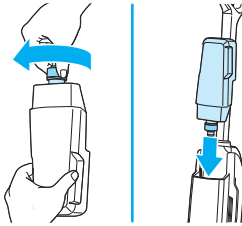

5. Screw cap back on. Align clean water tank with grooves on back of machine and slide it until it clicks into place.

*Compatible BISSELL formulas include: Hard Floor Sanitise, Multi-Surface, Wood Floor, Multi-Surface Pet (Ambipur). Certain trademarks used under license from The Procter & Gamble Company or its affiliates.

⚠ WARNING To reduce the risk of fire and electric shock due to internal component damage, use only BISSELL formula intended for use with this machine. Use of cleaning formulas that contain eucalyptus, lemon or pine oil may damage this appliance and void the warranty. Chemical spot cleaners or solvent-based soil removers should not be used. These products may react with the plastic materials used in your carpet washer causing cracking or pitting.

Cleaning Your Floors

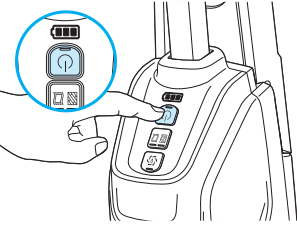

1. Press power button to turn machine ON. Default mode is Hard Floor Mode. Battery Run Time: Up to 22 minutes.

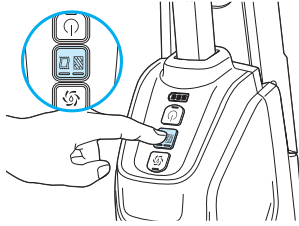

2. Press multi-surface button to switch between Hard Surface Mode and Area Rug Mode.

Hard Floor: Vacuums everyday messes on sealed hard floors, like tracked-in mud, spilled cereal and milk, coffee, and more.

Area Rug: Refresh and clean dry messes, like crumbs, dirt, hair, and more.



3. Recline machine to start brush roll spinning, suction, and spray. Machine will dispense cleaning fluid automatically while machine is reclined.



4. It may take up to 15 seconds to fully wet brush roll. For best results, use steady forward and backward strokes. Cleaning solution will be dispensed automatically during use. The clean water may remain visibly wet on the surface for several minutes after application.

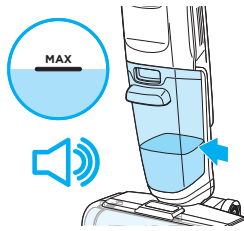

5. Do not let the water level fill above the "MAX" line. Float will engage when dirty water tank is full. Suction will decrease significantly & sound of machine will change. Empty dirty water tank regularly to maintain optimal performance.

Emptying the Dirty Water Tank

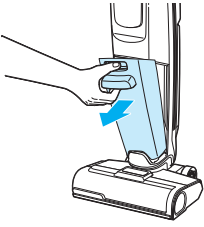

1. To remove dirty water tank, press dirty water tank release button, grab front handle and pull out.



2. Hold top of tank near sides of filter and pull up to remove. Remove debris from filter and mesh screen.

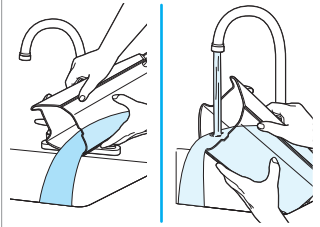

3. Empty and rinse dirty water tank.

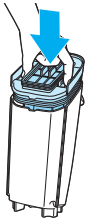

4. Install lid onto dirty water tank.

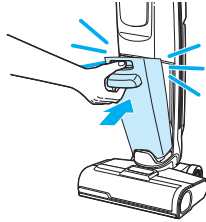

5. Install bottom of tank first. Tilt tank towards machine until it clicks into place.

Using the Clean-Out Cycle

Note: Empty dirty water tank before beginning and make sure filter stays dry. Use clean-out cycle after each use.

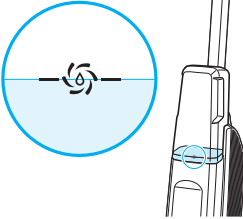
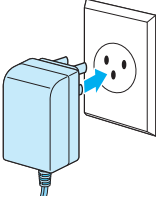
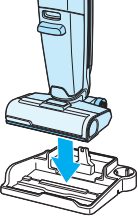
 <p>A circular inset shows a close-up of a water tank with a horizontal line indicating the fill level. A blue water droplet icon is positioned above the line. To the right, a partial view of the machine's water tank is shown with a blue line indicating the fill level.</p>	 <p>A blue rectangular charging cable with a two-prong electrical plug is shown being inserted into a standard wall outlet. A blue arrow points from the plug towards the outlet.</p>	 <p>The machine is shown being lowered into a docking station. A blue arrow points downwards from the machine towards the docking station, indicating the direction of movement.</p>
<p>1. Make sure water reaches clean-out cycle line on clean water tank. Refill with water if needed.</p>	<p>2. Insert charging cable plug into the outlet.</p>	<p>3. Note: Clean-out cycle will only run with machine in docking station.</p>

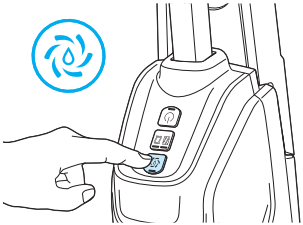
 <p>A hand is shown pressing a button on the control panel of the machine. A circular inset in the top left corner shows a blue water droplet icon with a circular arrow around it, representing the clean-out cycle.</p>	<p>4. Press the clean-out cycle button to begin. Run time is 40 seconds long. Empty dirty tank after running clean out cycle. It is recommended to remove brush roll and place in brush roll holder on docking station to air dry.</p>
---	---

Changing the Brush Roll

Visit [bissell.com.au](https://www.bissell.com.au) to purchase additional brush rolls.

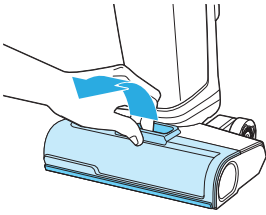

1. Press brush roll window release and pull window toward you to remove.

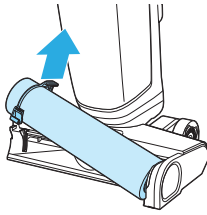

2. Pull brush roll tab to remove.

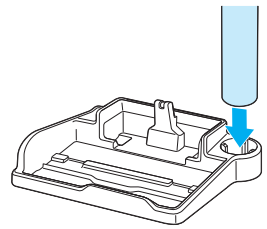

3. Place brush roll in brush holder on docking station to air dry.

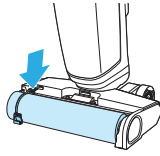
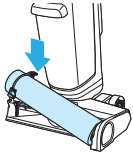

4. Install brush roll, insert right side of brush roll first and rotate downward until tab on left side of brush is locked in place.

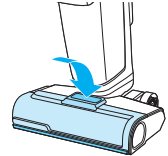
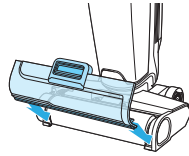

5. Install window by lining up tabs on bottom edges of foot and rotating towards machine. Press down until window clicks into place.

After-Cleaning Care



<p>1. Remove brush roll window and brush roll. Place brush roll in holder on dock. Allow brush roll to air dry completely before installing (see page 8).</p>	<p>2. Remove machine from docking station and wipe excess water or dirt.</p>	<p>3. Empty dirty water tank.</p>
<p>4. Remove filter from lid. Open screen and remove debris.</p>	<p>5. Wash filter in warm water. Clean and dry filter completely after each use. Replace every 3 months.</p>	<p>6. Rinse the tank lid and float to remove any debris and ensure float moves freely.</p>
<p>7. Let parts air dry completely before installing.</p>	<p>8. Install brush roll following steps on page 8. Install filter and tank lid.</p>	<p>9. Install bottom of tank first. Pivot top toward the machine until it clicks.</p>

Note: Any other maintenance or servicing not included in this manual should be performed by an authorised service representative.

Storing Your Machine

Store unit indoors in a dry location in an area where the product is not likely to get damaged. Replace filter and brushroll as needed or every 3 months.

Troubleshooting

Problem	Possible Cause	Remedies
Reduced or no spray	Clean water tank may be empty or seated incorrectly.	Refill and reinstall the clean water tank.
	System isn't completely primed.	Ensure clean tank is full and allow machine to run for 15-20 seconds to fully prime.
	Clean tank filter is dirty.	Remove clean tank from machine and locate small white foam filter under where the tank connects to the body. Clean any debris from foam filter and install.
Loss of suction or streaking	Tanks may not be seated properly.	Remove both tanks and reseal them so they fit properly on machine.
	Dirty water tank is full.	Empty dirty water tank.
	Brush window is not latched in place.	Power OFF machine and reinstall window.
	Debris channel in foot is clogged by debris.	Clean channel with a paper towel.
Brush roll is not turning	Filter is clogged by debris / or is wet	Remove filter and clean debris from filter. Let air dry completely before installing.
	Brush roll is not installed properly.	Follow instructions on page 8 for replacing brush roll.
	Machine is standing upright.	Step on foot and recline body of machine to turn brush roll on.
Machine is leaking	Brush roll stalled by debris.	Power OFF machine. Remove brush window and brush roll to remove obstruction.
	Cap of clean water tank is not installed properly.	Remove clean water tank and reinstall cap. Make sure cap is align and secured.
Battery icon blinking	Battery communication error.	Contact BISSELL Consumer Care.
Machine stops running and two lights of mode button are blinking	Brush roll stalled by debris.	Press power button to clear error. Remove brush roll and clean any debris from brush roll and brush roll gear. Install brush roll and brush roll window, and power back ON.
Machine stops running and two lights of mode button are blinking and clean-out cycle light is blinking	Machine may be overheating.	Turn machine OFF, and allow to cool for 10 minutes.

Limited Warranty

This limited warranty is provided by BISSELL® International Trading Company B.V. ("BISSELL") and applies in Australia and New Zealand. It gives you specific rights. It is offered as an additional benefit to your rights under law. You also have other rights under The Australian Consumer Law or New Zealand Consumer Laws, whichever applies to you. You can find out about your legal rights and remedies by contacting your local consumer advice service. Nothing in this warranty will replace or lessen any of your legal rights or remedies. If you need additional instruction regarding this warranty or have questions regarding what it may cover, please contact BISSELL Consumer Care or contact your local distributor.

This warranty is given to the current owner of the product with the original sales receipt. The original sales receipt must include the product(s) purchased, the date purchased, and which country it was purchased from new. You must be able to evidence the date of purchase and show the product was purchased in Australia or New Zealand to submit a claim under this warranty. You will receive the warranty that is applicable to the country where your product was originally purchased, as shown on the original sales receipt. If you use the product outside of the country where it was purchased, your warranty may be void in BISSELL's sole discretion. It may be necessary to obtain some of your personal information, such as a mailing address, to fulfill the terms of this warranty. Any personal data will be handled pursuant to BISSELL's Privacy Policy, which can be found at global.BISSELL.com/privacy-policy.

Limited Two-Year Warranty

For two years from the date of purchase by the original purchaser, subject to the *EXCEPTIONS AND EXCLUSIONS identified below, BISSELL will repair or replace (with new, refurbished, lightly used, or remanufactured components or products), at BISSELL's option, free of charge, any defective or malfunctioning part or product.

BISSELL recommends that the original packaging and original proof of purchase with the date of purchase and country where purchased be kept for the duration of the warranty period in case you want to redeem the warranty during the warranty period. Keeping the original packaging will assist with any necessary re-packaging and transportation but is not a condition of the warranty.

If your product is replaced by BISSELL under this warranty, then the new item will benefit from the remainder of the term of this warranty (calculated from the date of the original purchase). The period of this warranty shall not be extended whether or not your product is repaired or replaced.

*Conditions of Warranty

This warranty applies to products used for personal domestic use and not commercial or hire purposes. Consumable components and attachments such as filters, belts, shells, water tanks, scraping strips, brushes, and mop pads, which must be replaced or serviced by the user from time to time, are not covered by this warranty.

This warranty does not apply to any defect arising from fair wear and tear, including but not limited to the battery discharging time shortening due to the aging or use. Damage or malfunction caused by the user or any third party whether as a result of accident, negligence, abuse, neglect, or any other use not in accordance with the user guide is not covered by this warranty. An unauthorised repair (or attempted repair) may void this warranty whether or not damage has been caused by that repair/attempt. Removing or tampering with the Product Rating Label on the product or rendering it illegible will void this warranty.

Except as set out below, BISSELL and its distributors are not liable for any loss or damage that is not foreseeable or for incidental or consequential damages of any nature associated with the use of this product including without limitation loss of profit, loss of business, business interruption, loss of opportunity, distress, inconvenience, or disappointment. Except as set out below, BISSELL's liability will not exceed the purchase price of the product.

BISSELL does not exclude or limit in any way its liability for (a) death or personal injury caused by our negligence or the negligence of our employees, agents or subcontractors; (b) fraud or fraudulent misrepresentation; (c) or for any other matter which cannot be excluded or limited under law.

To make a claim under this warranty contact BISSELL Australia PTY LTD (details below). Contact BISSELL prior to returning any goods. Where agreed, BISSELL will reimburse reasonable postage / handling costs (if any) for returning goods to BISSELL. To claim expenses incurred in making a claim under this warranty please provide BISSELL with a copy of the receipt of the expenses by email or post.

For Australian Consumers Only: Our goods come with guarantees that cannot be excluded under the Australian Consumer Law. You are entitled to a replacement or refund for a major failure and compensation for any other reasonably foreseeable loss or damage. You are also entitled to have the goods repaired or replaced if the goods fail to be of acceptable quality and the failure does not amount to a major failure.

Important Notes

Please keep your original sales receipt. It provides proof of the date of purchase and where it was purchased in the event of a warranty claim. See warranty for details.

Please note that using your BISSELL machine outside of its country of original purchase and/or use with a power converter may damage your BISSELL machine and damage caused by mismatched power voltage will not be covered by your warranty.

Please note that putting vinegar, bleach, dish soap, detergent, homemade soap, and other non-BISSELL products in your BISSELL machine may damage your BISSELL machine. Damage caused by using non-BISSELL products in your machine will not be covered by your warranty.

Consumer Care

If your BISSELL product should require service or to claim under our limited guarantee, please contact us.



Australia

Telephone: 1300 247 735
Website: BISSELL.com.au
Address: 789 Springvale Road,
Mulgrave, Victoria 3170
Email: consumercareau@bissell.com



New Zealand

Telephone: 0800 247 735
Website: BISSELL.co.nz
Address: 789 Springvale Road,
Mulgrave, Victoria 3170
Email: consumercarenz@bissell.com

Need more support?

Head to <https://bissell.com.au/pages/contact> to troubleshoot, register your product, view your warranty, and more.



INFO



REGISTER



VIDEOS



PARTS



SUPPORT



©2026 BISSELL Inc. All rights reserved.
Part Number 1652275 12/25 v5